

GROUP 14—STEERING

1401—STEERING CONNECTING ROD (DRAG LINK) AND BELL CRANK

14-1	H012-07-09455	FM-GPW-3171	WO-A-857	BEARING, steering bell crank (SP-17212) (TR-B-1210).....	2	.179
	G503-7086585	FM-GPW-3332-A	WO-A-622	COVER, dust, steering connecting rod (rubber) (CA-S-X-1109) (also in KIT, FM-GPW-18383, WO-A-6791).....	2	
10-1, 3	3320-GPW-3131	FM-GPW-3131	WO-A-1211	CRANK, bell, steering drag link (superseded by CRANK, FM-GPW-3131-B, WO-A-8249).....	1	2.25
	8080-17307	FM-GPW-3131-B	WO-A-8249	CRANK, bell, steering drag link (SP-17307) (supersedes CRANK, FM-GPW-3131, WO-A-1211).....	1	
14-1	3320-GPW-18383	FM-358006-S8	WO-A-5691	CRANK, bell, steering drag link (<i>Note 1</i>).....	1	
		FM-GPW-18383	WO-640038	FITTING, lubricating, hydraulic type, straight, ball seal, 1/8-27NPT (AD-1980).....	3	
		FM-GPW-3332-A	WO-A-6791	KIT, repair, steering connecting rod.....	1	.472
		FM-GPW-3323	WO-A-622	(Consists of:		
			WO-630756	2 COVER		
				1 PLUG, adjusting, large		

		FM-GPW-3328	WO-630757	1 PLUG, adjusting, small		
		FM-GPW-3326	WO-630753	2 PLUG, ball seat		
		FM-GPW-3320	WO-630755	3 SEAT, ball		
		FM-GPW-3336	WO-A-623	2 SHIELD		
		FM-GPW-3327	WO-630754	2 SPRING		
14-1	8080-17211 3320-GPW-3323	FM-GPW-3166	WO-A-856	PIN, steering bell crank shaft (S., tapered, $\frac{3}{8}$ x $1\frac{1}{8}$) (SP-17211)	1	.0367
		FM-GPW-3323	WO-630756	PLUG, adjusting, steering connecting rod ball seat (slotted, large) (CA-S-5070) (also in KIT, FM-GPW-18383, WO-A-6791)	1	
14-1	H001-0811055 G503-7036586	FM-72089-S	WO-5134	PIN, cotter, split, S., $\frac{1}{8}$ x $1\frac{3}{4}$	1	
		FM-GPW-3328	WO-630756	PLUG, adjusting, steering connecting rod ball seat (slotted, small) (CA-S-5143) (also available as part of KIT, FM-GPW-18383, WO-A-6791)	1	
14-1	H001-0811055	FM-72089-S	WO-5134	PIN, cotter, split, S., $\frac{1}{8}$ x $1\frac{3}{4}$	1	

Note 1—Only for vehicles modified by MWO ORD G503-W8.

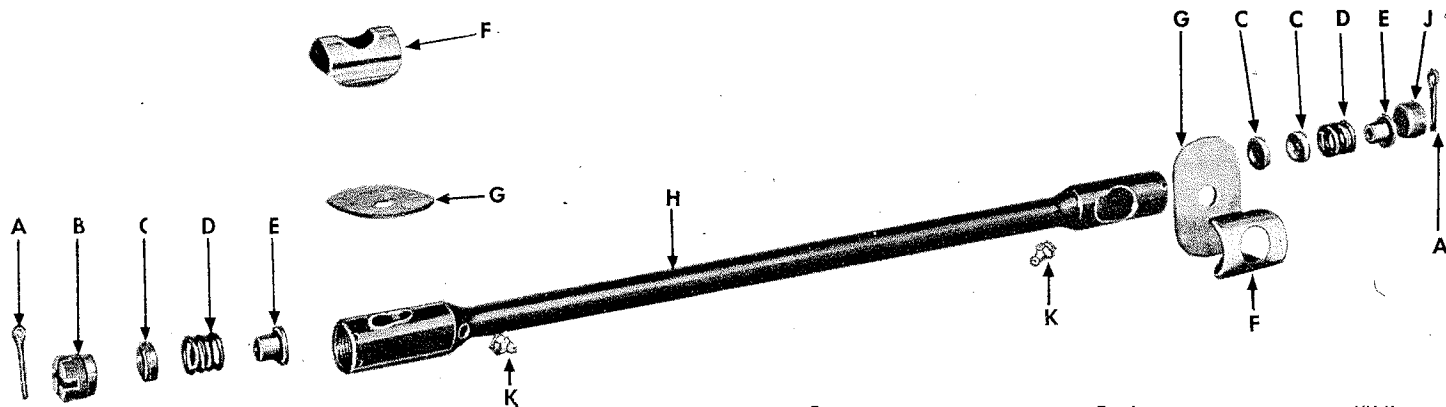

Key	Part Name	Ford Part No.	Willys Part No.	Group Number
A	PIN	FM-72089-S	WO-5134	1401
B	PLUG	FM-GPW-3323	WO-630756	1401
C	SEAT	FM-GPW-3320	WO-630755	1401
D	SPRING	FM-GPW-3327	WO-630754	1401
E	PLUG	FM-GPW-3326	WO-630753	1401
F	SHIELD	FM-GPW-3336	WO-A-623	1401
G	COVER	FM-GPW-3332-A	WO-A-622	1401
H	ROD, assembly	FM-GPW-3304-B	WO-A-8250	1401
J	PLUG	FM-GPW-3328	WO-630757	1401
K	FITTING	FM-358006-S8	WO-640038	1401

FIGURE 14-1—STEERING CONNECTING ROD—EXPLODED VIEW

GROUP 14—STEERING

Figure Number	Official Stock Number	Piece Mark or Part Number		ITEM	Quant. Req'd. per Unit Assy.	Unit Price
		Ford No.	Willys No.			
Col. 1	Col. 2	Col. 3	Col. 4	Col. 5	Col. 6	Col. 7
1401—STEERING CONNECTING ROD (DRAG LINK) AND BELL CRANK (Cont'd)						
14-1	G503-7036588	FM-GPW-3326	WO-630753	PLUG, steering connecting rod ball seat spring (CA-S-5144) (also in KIT, FM-GPW-18393, WO-A-6791)	2	
		FM-GPW-3305-B	WO-A-8252	ROD, connecting, steering (CA-D-822)	1	
	9680-A-621	FM-GPW-3305	WO-A-621	ROD, connecting, steering	1	
	G503-0373279	FM-GPW-3304	WO-A-619	ROD, connecting, steering, assembly (superseded by ROD, assembly, FM-GPW-3304-B, WO-A-8250)	1	1.19
14-1	3320-GPW-3304-B	FM-GPW-3304-B	WO-A-8250	ROD, connecting, steering, assembly (supersedes ROD, assembly, FM-GPW-3304, WO-A-619)	1	
	8080-17213	FM-GPW-3167	WO-A-858	SEAL, steering bell crank shaft bearing (SP-17213) (also in GASKET SET, FM-GPW-18365-B, WO-A-7830)	2	.0057
14-1	G503-7036567	FM-GPW-3320	WO-630755	SEAT, ball, steering connecting rod (CA-S-5069) (also in KIT, FM-GPW-18383, WO-A-6791)	3	
	8080-17210	FM-GPW-3165	WO-A-855	SHAFT, steering bell crank	1	1.124
10-1		FM-356124-S	WO-A-876	NUT, slotted, hex., S., 3/4-20NF-2 (SP-S-1106)	1	.0342
	H001-0811055	FM-72089-S	WO-5134	PIN, cotter, split, S., 1/8 x 1 3/4	1	
	8080-17205	FM-GPW-3170	WO-A-861	SHIELD, dust, steering bell crank bearing (SP-17205)	1	.0121
14-1	G503-7036584	FM-GPW-3336	WO-A-623	SHIELD, dust, steering connecting rod dust cover (CA-S-X-1110) (also in KIT, FM-GPW-18383, WO-A-6791)	2	
14-1	G503-7036587	FM-GPW-3327	WO-630754	SPRING, steering connecting rod ball seat (CA-S-5145) (also in KIT, FM-GPW-18383, WO-A-6791)	2	
	8080-17215	FM-GPW-3169	WO-A-860	WASHER, steering bell crank shaft, lower (SP-17215)	1	.0152
	8080-17214	FM-GPW-3168	WO-A-859	WASHER, steering bell crank shaft, upper (SP-17214)	1	.0122
1402—TIE ROD						
10-3, 5	8080-13439	FM-51-3287	WO-A-1706	CLAMP, steering knuckle tie rod socket (SP-13439) (TP-16MN8)	4	.0641
10-5		FM-24916-S2	WO-A-1707	BOLT, hex-hd., S., 3/8-24NF x 1 5/8 (SP-6-73-326) (TP-6MN27)	4	
10-5		FM-33800-S7	WO-52542	NUT, reg, hex., S., cd-pltd., 3/8-24NF-2	4	
	H001-1518009	FM-34807-S2	WO-5010	WASHER, lock, reg., S., 3/8 in.	4	
	G085-2371582	FM-78-3336	WO-A-844	COVER, dust, steering knuckle tie rod socket (SP-16067) (TP-14DM-43)	2	
	8080-17047-X	FM-GP-3290		END, steering knuckle tie rod, left, assembly (SP-17047-X) (superseded by END, assembly, FM-GP-3292, WO-A-847)	2	
10-1, 3, 5		FM-GP-3292	WO-A-847	END, steering knuckle tie rod, left, assembly (SP-17047-X) (TP-14SV90-A-7) (supersedes END, assembly, FM-GP-3290)	2	.489

	8080-17046-X	FM-GP-3289	
10-1, 3		FM-GP-3291	WO-A-838
10-5		FM-351059-S7	WO-10558
10-5	H001-0811040	FM-72034-S	WO-A-1642
	G503-0373270	FM-GPW-3280	WO-A-1704
	G503-0373269	FM-GPW-3279	WO-A-1708
	3320-783332-A	FM-78-3332-A	
10-1, 3	8080-17295-2	FM-GPW-3282	WO-A-6305
10-1, 3, 5	8080-17295-1	FM-GPW-3281	WO-A-1709
			WO-A-1705
14-2	3320-GPW-3590	FM-GPW-3590	WO-A-1116
14-2	7640-025060	FM-356077-S8	WO-639115
14-2	H001-1518013	FM-34811-S	WO-5038
14-2	H002-0100130	FM-GPW-3571	WO-639104
14-2	7640-063996	FM-GPW-3517	WO-639190
14-2	7640-063011	FM-GPW-3587	WO-639090
14-2	7640-063012	FM-GPW-3576	WO-639091
14-2	3320-GPW-3509	FM-GPW-3509	WO-A-1199
	9680-390510		WO-390510
14-2	7640-502540	FM-GPW-3583	WO-639116
		FM-20386-S7	WO-51486
		FM-34836-S7	WO-5051
14-2	7640-T-126000	FM-GPW-3568	WO-A-1760
	7640-020122	FM-355426-S	WO-639107
	G085-1543023	FM-356303-S	WO-639121
		FM-34836-S7	WO-5051
14-2	H012-6200730	FM-GPW-3552	WO-639102
14-2	7640-T-129001	FM-GPW-3581	WO-639119
	7640-T-13086	FM-GPW-3504	WO-A-1239
14-2	7640-503284	FM-GPW-3545	WO-A-740
		FM-24555-S	WO-51371
		FM-355433-S2	
			WO-51612
		FM-33802-S2	WO-5939
		FM-34921-S	WO-52874
14-2	H013-0500017	FM-GPW-3591-A	WO-639095
14-2		FM-74121-S	WO-51091
14-2		FM-358064-S	WO-5085
14-2	7640-401100	FM-GPW-3589	WO-639103
14-2	7640-021116	FM-GPW-3577	WO-639718
14-2		FM-33927-S7	WO-52925
14-2	7640-028093	FM-GPW-3518	WO-639192

END, steering knuckle tie rod, right, assembly (SP-17046-X) (superseded by END, assembly, FM-GP-3291, WO-A-838)	2	
END, steering knuckle tie rod, right, assembly (SP-17046-X) (TP-14SV89-A-7) (super-sedes END, assembly, FM-GP-3289)	2	.489
NUT, hex., slotted, S., 1/2-20NF	4	
PIN, cotter, split, S., 3/32 x 1	4	
ROD, tie, steering knuckle, right, assembly (SP-17308-X) (includes tie rod END)	1	2.61
ROD, tie, steering knuckle, left, assembly (SP-17309-X) (includes tie rod END)	1	2.35
SEAL, dust, steering knuckle tie rod (Ford only)	4	
SPRING, steering knuckle tie rod socket stud (SP-17347) (TP-14-DS-20) (Willys only)	4	
TUBE, steering knuckle left tie rod (14 3/4 in. long) (SP-17295-2)	1	
TUBE, steering knuckle right tie rod (21.80 in. long) (SP-17295-1)	1	

1403A—GEAR ASSEMBLY

ARM, steering gear	1	.961
NUT, hex., S., 5/8-18NF-2	1	
WASHER, lock, reg., S., 5/8 in.	1	
BALL, chr-alloy-S., Grade 2, 5/16 in. (steering gear worm)	22	.0055
BEARING, steering column, wheel end, assembly (RG-063996)	1	.138
BUSHING, steering gear housing, inner (RG-063011) (RG-063019)	1	.0306
BUSHING, steering gear housing, outer (RG-063012) (RG-063020)	1	.0371
COLUMN, steering, w/BEARING, assembly	1	.717
COVER, steering column oil hole (Willys only)	1	
COVER, steering gear housing, side, assembly (GR-502540)	1	.619
BOLT, hex-hd., s-fin., S., cd-pltd., 3/16-18NC-2 x 1	4	
WASHER, lock, hv., S., cd-pltd., 5/16 in.	4	
COVER, steering gear housing, upper (RG-T-126000)	1	.228
BOLT, hex-hd., s-fin., alloy-S., 3/16-18NC-2 x 3/4 (RG-020122)	3	.0258
WASHER, copper (RG-092021)	3	.0083
WASHER, lock, hv., S., cd-pltd., 5/16 in.	3	
CUP, steering gear worm ball (RG-400025)	2	.117
GASKET, steering gear housing side cover (RG-T-129001)	1	.0036
GEAR, steering, w/o WHEEL, assembly (RG-T-13086)	1	9.074
HOUSING, steering gear, assembly (RG-503284)	1	2.139
BOLT, hex-hd., S., 7/16-20NF-2 x 3	2	
BOLT, hex-hd., S., 7/16-20NF-2 x 4 (Ford only)	1	
BOLT, hex-hd., S., 7/16-20NF-2 x 4 (Willys only)	1	
NUT, reg., hex., S., 7/16-20NF-2	3	
WASHER, lock, hv., S., internal tooth, flat type, 1/16 in.	3	
OIL SEAL, steering gear lever shaft (RG-032075)	1	.102
PLUG, expansion, steering gear housing (1 1/4 in.)	1	
PLUG, filler, steering gear housing (pipe, I., 1/8 in.)	1	
RING, retaining, steering gear worm ball (RG-401100)	2	.0023
SCREW, adjusting, steering gear lever shaft (RG-021116)	1	.07
NUT, thin, hex., S., cd-pltd., 3/16-20	1	
SEAT, steering column upper bearing spring (RG-028093)	1	.0081

Key	Part Name	Ford Part No.	Willys Part No.	Group No.
A	WHEEL	FM-GPW-3600-A	WO-A-6858	1404
B	BEARING	FM-GPW-3517	WO-639190	1403A
C	SEAT	FM-GPW-3518	WO-639192	1403A
D	SPRING	FM-GPW-3520	WO-639191	1403A
E	NUT	FM-GPW-3655	WO-A-633	1404
F	BUTTON	FM-GPW-3627	WO-A-634	0609B
G	WASHER	FM-GPW-3631	WO-A-750	0609B
H	FERRULE	FM-GPW-3635-B	WO-A-751	0609B
J	SPRING	FM-GPW-3626	WO-638884	0609B
K	CUP	FM-GPW-3646	WO-638885	0609B
L	CABLE, assembly	FM-GPW-14171	WO-A-752	0609B
M	COLUMN, assembly	FM-GPW-3509	WO-A-1199	1403A
N	CLAMP, assembly	FM-GPW-3506	WO-A-635	1405
P	SHIM SET	FM-GPW-18374	WO-A-6760	1403A
Q	RING	FM-GPW-3589	WO-639103	1403A
R	CUP	FM-GPW-3552	WO-639102	1403A
S	SHAFT, and WORM, assembly	FM-GPW-3514	WO-A-8838	1403A
T	PLUG	FM-358064-S	WO-5085	1403A
U	SHAFT, assembly	FM-GPW-3575	WO-A-745	1403A
V	GASKET	FM-GPW-3581	WO-639119	1403A
W	SCREW	FM-GPW-3577	WO-639118	1403A
X	NUT	FM-33927-S7	WO-52925	1403A
Y	COVER	FM-GPW-3583	WO-639116	1403A
Z	HOUSING, assembly	FM-GPW-35415	WO-A-740	1403A
AA	PLUG	FM-74121-S	WO-51091	1403A
AB	BUSHING	FM-GPW-3587	WO-639090	1403A
AC	BUSHING	FM-GPW-3576	WO-639091	1403A
AD	ARM	FM-GPW-3590	WO-A-1116	1403A
AE	WASHER	FM-34811-S	WO-5038	1403A
AF	NUT	FM-356077-S8	WO-639115	1403A
AG	OIL SEAL	FM-GPW-3591-A	WO-639095	1403A
AH	BALLS	FM-GPW-3571	WO-639104	1403A
AJ	COVER	FM-GPW-3568	WO-A-1760	1403A
AK	RING	FM-GPW-3652	WO-A-747	0609B
AL	BRUSH	FM-GPW-13836	WO-A-302	0609B

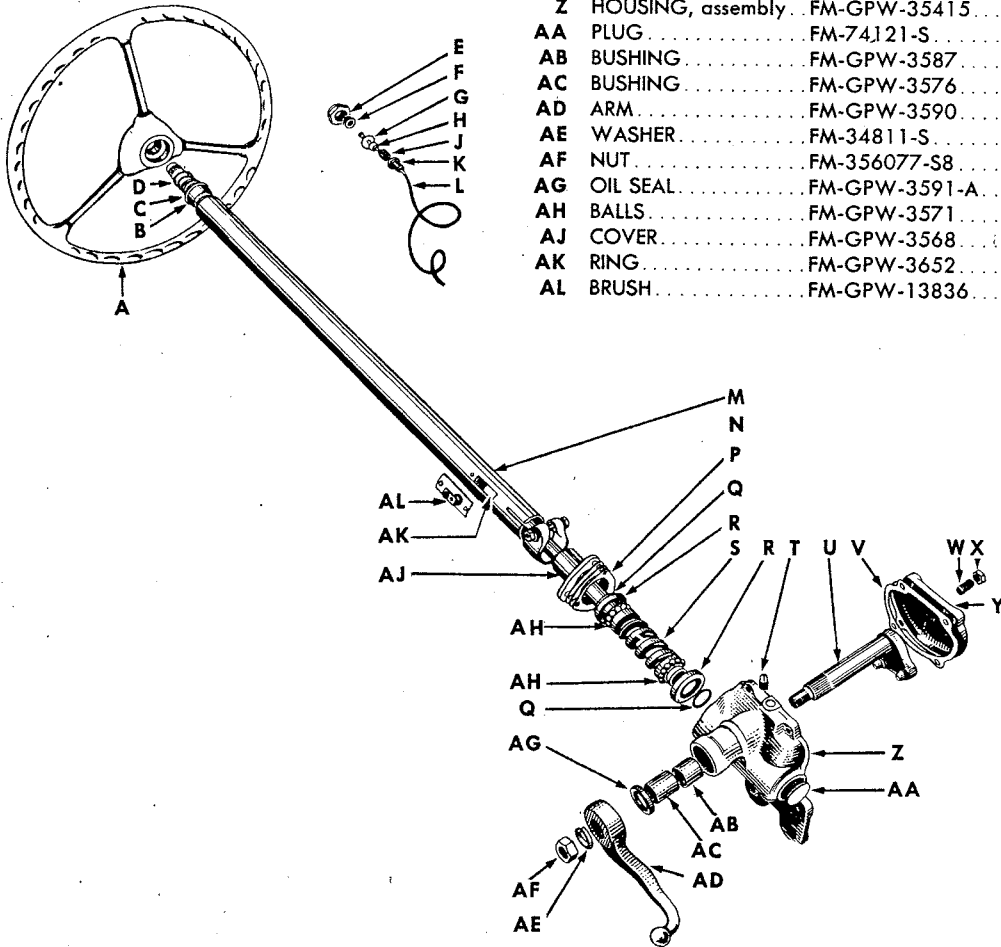

RA PD 342246

FIGURE 14-2—STEERING GEAR ASSEMBLY—EXPLODED VIEW

GROUP 14—STEERING

Figure Number	Official Stock Number	Piece Mark or Part Number		ITEM	Quant. Req. per Unit Assy.	Unit Price
		Ford No.	Willys No.			
Col. 1	Col. 2	Col. 3	Col. 4	Col. 5	Col. 6	Col. 7
1403A—GEAR ASSEMBLY (Cont'd)						
	7640-503308	FM-GPW-3524	WO-A-742	SHAFT and WORM, steering gear, w/horn button NUT, assembly (superseded by SHAFT, assembly, FM-GPW-3514, WO-A-8838)	1	2.51
14-2	7640-503308	FM-GPW-3514	WO-A-8838	SHAFT and WORM, steering gear, w/horn button NUT, assembly (RG-503308) (supersedes SHAFT, assembly, FM-GPW-3524, WO-A-742)	1	
14-2	F065-0101500	FM-GPW-3575	WO-A-745	SHAFT, lever, steering gear, assembly (RG-7698-4 $\frac{5}{8}$)	1	2.281
	3320-GPW-3563	FM-GPW-3563	WO-638918	SHIM, steering gear mounting	as req.	.0029
	7640-033046	FM-GPW-3593	WO-639108	SHIM, steering gear housing upper cover (S., 0.002 thk.) (RG-033046) (also in SHIM SET, FM-GPW-18374, WO-A-6760)	as req.	
	7640-033047	FM-GPW-3594	WO-639109	SHIM, steering gear housing upper cover (S., 0.003 thk.) (RG-033047) (also in SHIM SET, FM-GPW-18374, WO-A-6760)	as req.	
	7640-033048	FM-GPW-3595	WO-639110	SHIM, steering gear housing upper cover (S., 0.010 thk.) (RG-033048) (also in SHIM SET, FM-GPW-18374, WO-A-6760)	as req.	
14-2	3320-GPW-18374	FM-GPW-18374	WO-A-6760	SHIM SET, steering gear housing upper cover (Consists of: 2 SHIM, 0.002 thk. 2 SHIM, 0.003 thk. 2 SHIM, 0.010 thk.)	1	.11
	7640-033046	FM-GPW-3593	WO-639108	SNAP RING, steering column (Ford only)	2	.0036
	7640-033047	FM-GPW-3594	WO-639109	SPACER, steering gear to frame bolt	1	
	7640-033048	FM-GPW-3595	WO-639110	SPRING, steering column upper bearing (RG-401090)	1	.0033
	3320-GPW-3521	FM-GPW-3521	WO-A-1422	WASHER, S., 1/2 in. I.D. x 1/4 O.D. (steering gear slotted hole)	1	.0217
14-2	7640-401090	FM-GPW-3520	WO-639191			
		FM-356439-S	WO-638381			
1404—WHEEL ASSEMBLY						
	9680-A-535		WO-A-535	WHEEL, steering, assembly (hard rubber) (superseded by WHEEL, FM-GPW-3600-A, WO-A-6858)	1	
	9680-A-6343		WO-A-6343	WHEEL, steering, assembly (superseded by WHEEL, FM-GPW-3600-A, WO-A-6858)	1	
14-2; 18-1	3320-GPW-3600-A	FM-GPW-3600-A3 FM-GPW-3600-A	WO-A-6858	WHEEL, steering (superseded by WHEEL, FM-GPW-3600-A, WO-A-6858)	1	
				WHEEL, steering assembly (supersedes WHEEL, WO-A-535; and WHEEL, WO-A-6343; and WHEEL, FM-GPW-3600-A3)	1	3.05
14-2	7640-026988	FM-GPW-3655	WO-A-633	NUT, steering wheel and horn button (RG-026088)	1	.179

185

SNL G-503

1403A-1404

GROUP 14—STEERING

Figure Number	Official Stock Number	Piece Mark or Part Number		ITEM	Quant. Reqd. per Unit Assy.	Unit Price
		Ford No.	Willys No.			
Col. 1	Col. 2	Col. 3	Col. 4	Col. 5	Col. 6	Col. 7
				1405—BRACKETS		
14-2	7640-502282	FM-GPW-3682-A	WO-A-1277	BUSHING, steering column support.....	1	
	H001-0116196	FM-GPW-3506	WO-A-635	CLAMP, steering column, assembly (RG-502282).....	1	.108
	G166-0314832	FM-21492-S2	WO-51308	BOLT, hex-hd., s-fin., alloy-S., $\frac{5}{16}$ -24NF-2 x 2.....	1	
	H001-7025711	FM-33798-S7	WO-A-1532	NUT, reg., hex., s-fin., alloy-S., cd-pltd., $\frac{5}{16}$ -24NF-2.....	1	
		FM-34806-S7	WO-51833	WASHER, lock, reg., S., cd-pltd., $\frac{5}{16}$ in.....	1	
	H001-0116190	FM-GPW-3511	WO-A-1276	CLAMP, steering column support.....	1	.141
	G166-0314832	FM-24347-S2	WO-51396	BOLT, hex-hd., s-fin., alloy-S., $\frac{5}{16}$ -24NF-2 x $\frac{3}{4}$ (BAOX1BA).....	2	
	H001-7025711	FM-33798-S7	WO-A-1532	NUT, reg., hex., s-fin., alloy-S., cd-pltd., $\frac{5}{16}$ -24NF-2.....	2	
		FM-34806-S7	WO-51833	WASHER, lock, reg., S., cd-pltd., $\frac{5}{16}$ in.....	2	
		FM-GPW-3563	WO-638918	SHIM, mounting, steering column.....	as req.	.0029
		FM-GPW-3658	WO-A-2859	SUPPORT, steering column.....	1	.135
				GROUP 15—FRAME AND BRACKETS		